



Dene Gardens Stanmore £435,000

A three bedroom, two bathroom maisonette available chain free and in an excellent location with Davidson Frost-Wellings.

The property is available with a large reception room, leading to a private patio, plus a separate kitchen and additional dining room. The property has three bedrooms, a family bathroom and guest WC.

This maisonette also has communal gardens.

Dene gardens is a no-through road off Marsh Lane offering easy access to the shops, cafes and amenities of Stanmore Broadway, as well as Stanmore Tube Station.

Leasehold with 125 years remaining
Service Charge of £800 per annum.
Ground Rent of £100 per annum.
Harrow Council Tax Band E.

Viewing

Please contact our Davidson Frost-Wellings Office on 020 8954 8806 if you wish to arrange a viewing appointment for this property or require further information.

- Three bedrooms
- Two bathrooms
- Chain free
- Own entrance
- Two reception rooms
- Private terrace



3



2



2



D

Floor Plan

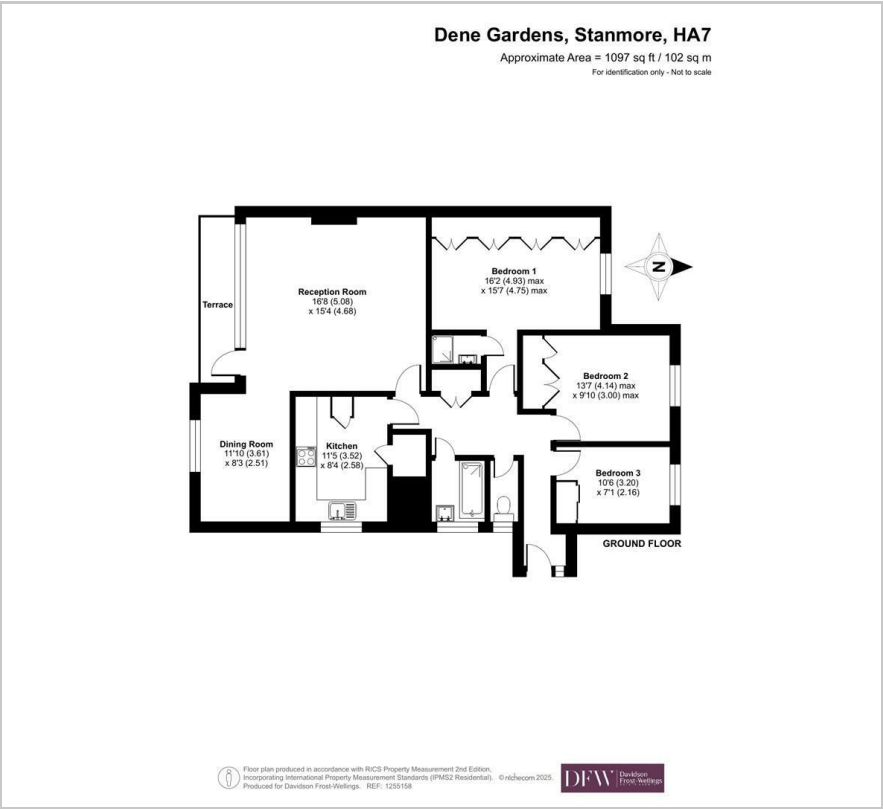

Area Map

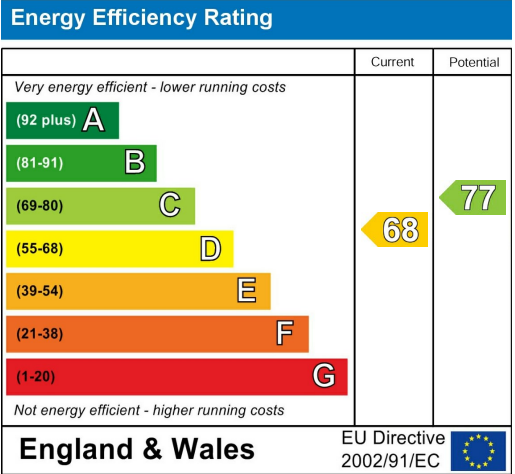

These particulars, whilst believed to be accurate are set out as a general outline only for guidance and do not constitute any part of an offer or contract. Intending purchasers should not rely on them as statements of representation of fact, but must satisfy themselves by inspection or otherwise as to their accuracy. No person in this firms employment has the authority to make or give any representation or warranty in respect of the property.